

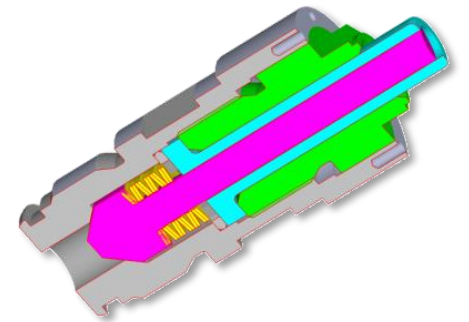

Gas Injection Technology for High Pressure Die Casting



**Magnesium and Aluminum
Gas-Injection-Technologie**

Gas Injection Technology for High Pressure Die Casting

Why and For Which Reason

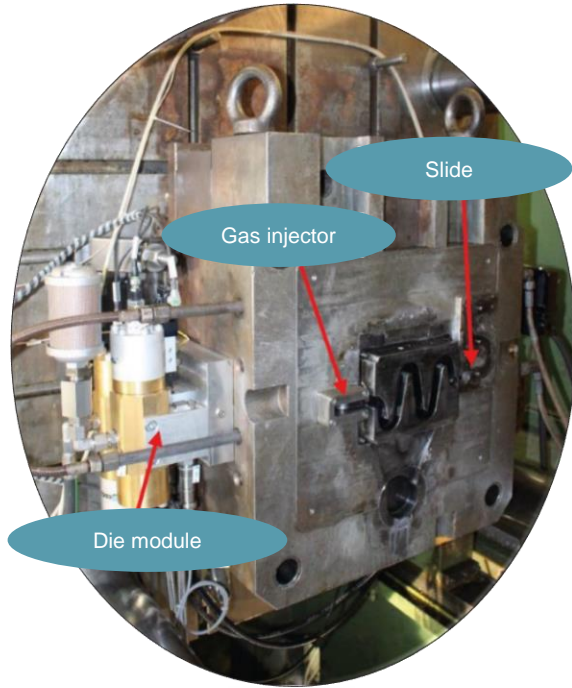

Greater latitude during product design



Production of complex geometries for hollow components



Reduced component costs through material savings



Machine-independent retrofitting on all cold and hot chamber HPDC systems

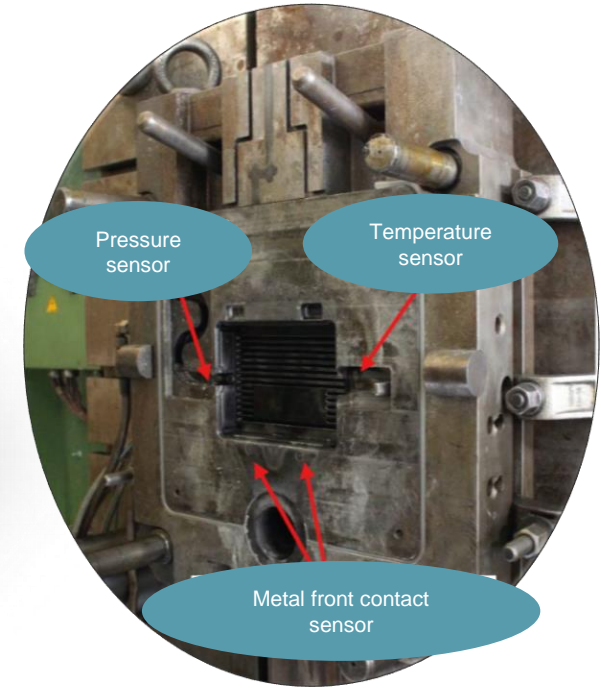

Gas Injection Technology for High Pressure Die Casting

Examples of Suitable Components

Housings with media lines:



Handles - Levers - Pedals:





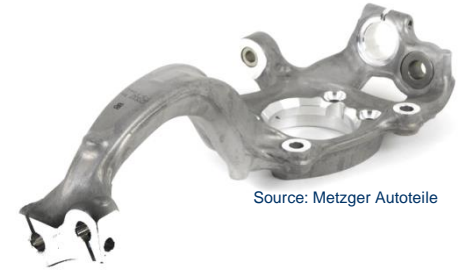

Structural components:



Fittings:



-  Weight reduction through avoidance of thick sections
-  Creation of cavities without additional processes
-  No lost sand or salt cores
-  Closed hollow components instead of ribbed structures sensitive to dirt

Gas Injection Technology for High Pressure Die Casting

Basic Principle of Gas Injection

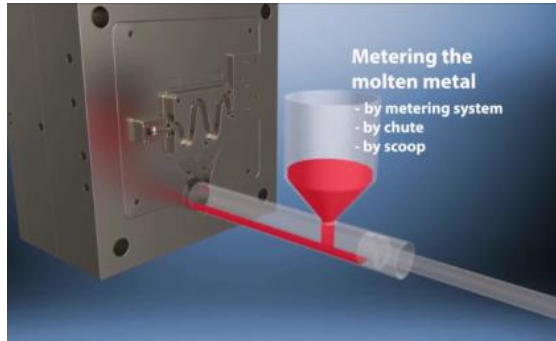

Melt dispensing

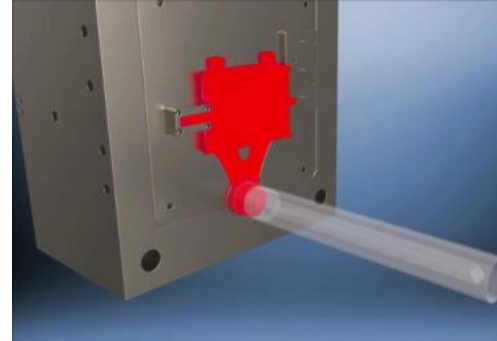

Cavity filling

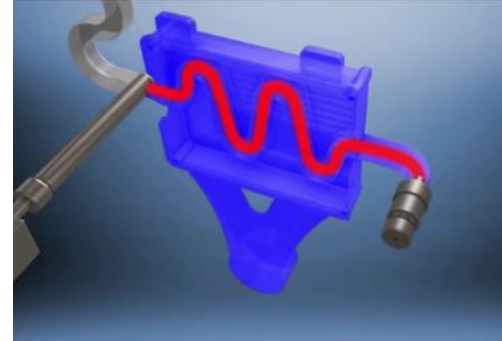

Gas pressure is built up



Injector penetrates

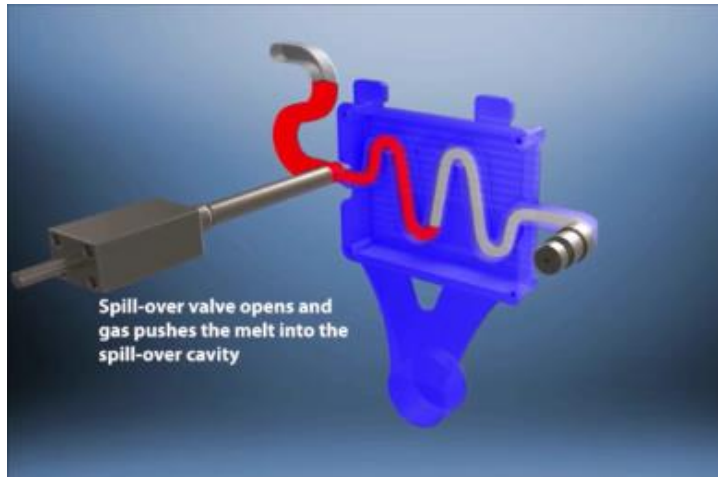

Liquid core is displaced into overflow cavity

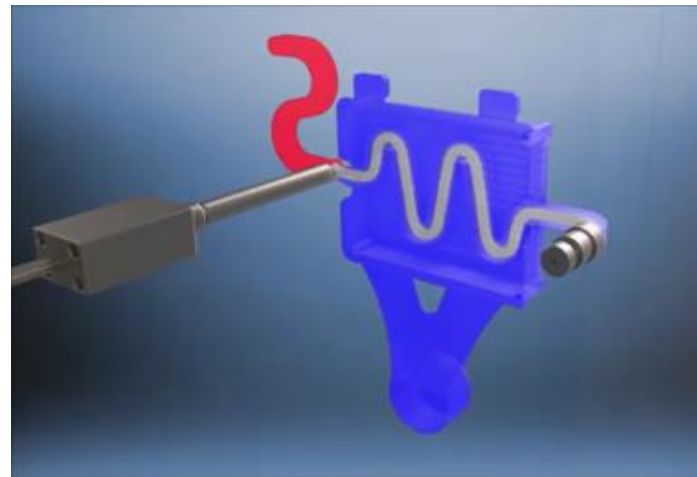

Gas retention and holding pressure phase

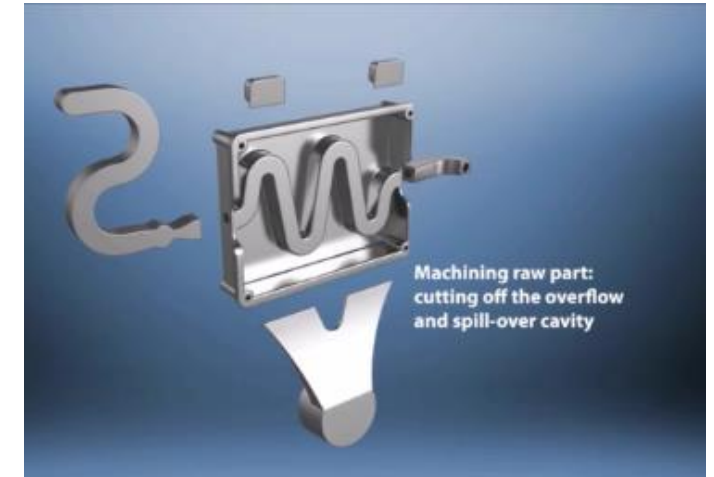

Completed component with cooling channel

Gas Injection Technology for High Pressure Die Casting

Structure of MAGIT System:



Tablet PC control

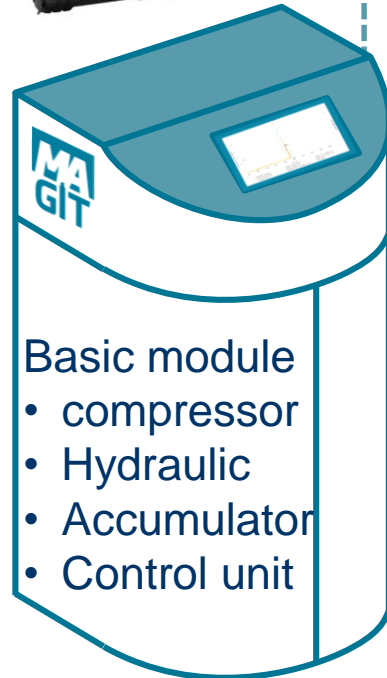

Sensor signals

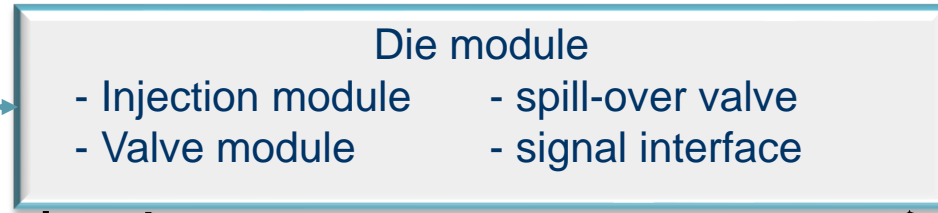

temperature

pressure

MFKS signal

gas

oil

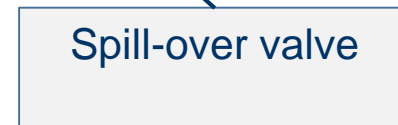
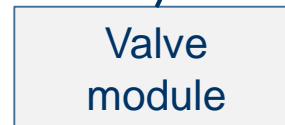

Gas Injection Technology for High Pressure Die Casting

Contact:



Interested?

Any other questions?

We'll be happy to advise you
Franz.krall@magit-hpdc.com

or

+49 173 8525112